



**Caution: New Model Available 3rd Quarter 2004. Dimensions May Change.**

## AutoSort 7 - Line Sorter Sort Station



### MECHANICAL CHARACTERISTICS

#### Medium Speed

**Bed Section:**

Mainline: 8" Deep x 1 3/8" Flange x 12 Gauge frame.  
 Spur: 13" Deep x 1 3/8" Flange x 12 Gauge frame. (V-belt Driven)

**Galvanized Rollers:**

1 7/8" Diameter 16 Gauge, carrying roller with 7/16" hex axle.

**Drive Shaft:**

1" diameter cold rolled shaft with standard spools and 3/16" dia.  
 83 durometer elastomeric drive belts.

**Sort Rate Capacity:**

Up to 60 Cartons per minute dependant upon carton size & weight and system design.

**Carton Weight Capacity:**

Up to 100 pounds, depending on lineshaft conveyor speed.

**Compatible Conveyor:**

Automotion Shaft Driven Live Roller Conveyor.

**Air Requirements:**

Nominal operating pressure is 40 psi.

**Diverter / Spur Drive:**

3/4 HP motor drives chain mounted divert tabs and v-belt on spur.

### FEATURES

Automotion Shaft Driven Live Roller conveyor is available in various configurations to support numerous system applications. It is quiet, safe, and offers high speed and reversibility. It can power curves, straights, and other accessories such as transfers, junctions, and merges with a single drive. It is ideally suited when diverse live roller applications are required in a small area.

Automotion's Shaft Driven Live Roller Conveyor reduces overall system cost while enhancing system capabilities and flexibility. Costs are reduced because transferring, merging, diverting, and accumulating beds can all be powered by a single drive. The driveshaft, common to each of the shaft driven beds, is easily coupled to the next downstream conveyor bed. This flexibility allows your system to grow and adapt as your needs change. The internalized drive shaft makes the conveyor beds forklift friendly when installing at higher elevations.

AutoSort 7 Line Sorter is a medium speed, positive divert sorter. This modular unit is available in right hand or left hand assemblies. The line sorter diverts product at a 30 degree angle onto the take-away. It utilizes two shafts that must be independently driven. Chain mounted tabs are pneumatically raised in the path of product to be diverted.



### SPECIFICATIONS

**Typical Applications:**

Shipping Sortation  
 Receiving Sortation  
 Zone Routing

**Live Load Capacity:**

Up to 20 lbs. per roller.

**Nominal Widths:**

18", 24", 30" & 36"

**Between Rail Widths:**

16", 22", 28" & 34"

**Roller Centers:**

2 1/4"

**Options:**

Guard Rails and Supports  
 Hi-Speed Rollers  
 Speed-Up Spools  
 Powder Coat or Galvanized Finish

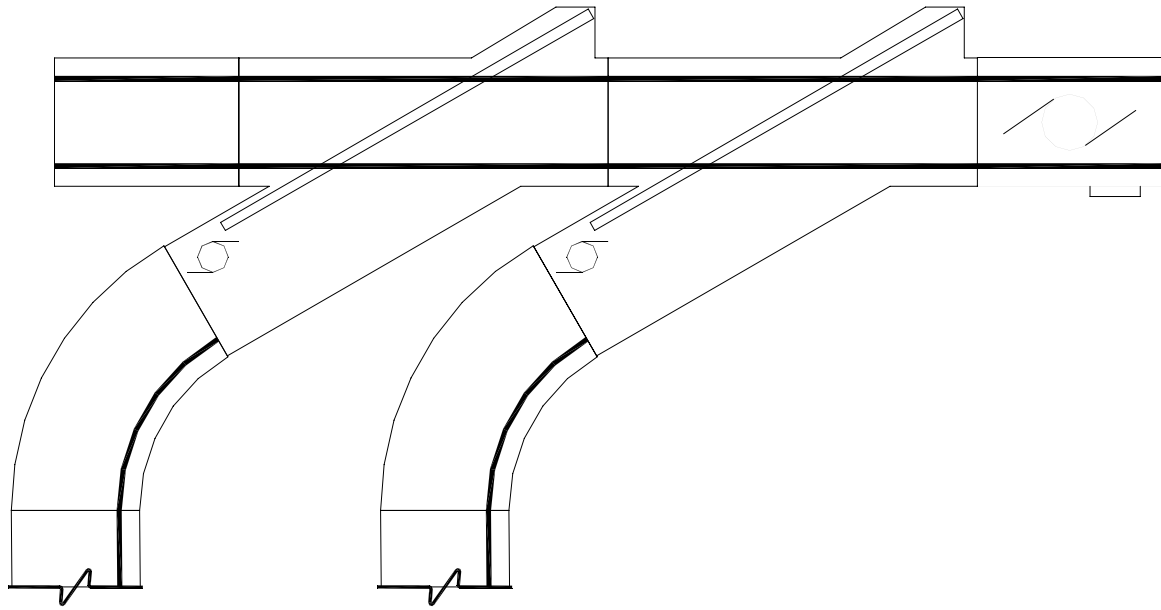

**11000 South Laverne Avenue Oak Lawn, Illinois 60453-5500**  
**Phone: 708-229-3700 Fax: 708-229-3799**  
**[www.automotionconveyors.com](http://www.automotionconveyors.com)**  
**[info@automotionconveyors.com](mailto:info@automotionconveyors.com)**